



**Dyna-Form<sup>®</sup>**

# Mercury Advance Alternating Cushion

The **Dyna-Form™ Mercury Advance Alternating Cushion** is a dynamic replacement seating system, combined with the benefits of modern foam technology. It is specifically designed for patients considered to be at **‘Very High Risk’** of pressure ulcer development. Offering high levels of patient comfort, this unique system has the facility to “step up” to that of a dynamic cushion when clinically required. Similarly, the cushion function can be ‘stepped down’ as the patient’s condition improves. A higher maximum weight capacity, up to 24 stone / 152kg, allows the product to meet the challenges of heavier patients.

The outer cover comprising a high frequency welded, multi stretch and vapour permeable fabric satisfies the strictest infection control policies. Designed using the latest medical grade cell technology to create greater postural management and pressure relief, this product is specifically made for users considered to be at ‘Very High Risk’ of pressure ulcer development and those with minor postural issues.

## Technical Specifications

<b>Product Code</b>	<b>CUSH/ADV/ALT/46/46/10</b>
<b>Risk Category</b>	Very High Risk
<b>Weight Limit</b>	No minimum weight limit. Product evaluated to 24 stone / 152Kg capacity
<b>Warranty</b>	2 Years
<b>Dimensions</b>	(Length) 46cm x (Width) 46cm x (Height) 10cm (18" x 18" x 4") Variable sizes available upon request
<b>Product Weight</b>	1.3Kg Cushion / 1.7Kg Power Unit
<b>Cycle Time</b>	10 minutes
<b>Mode of Operation</b>	Electronic
<b>Voltage</b>	220V – 240V / 50HZ
<b>Power Consumption</b>	10W
<b>Colour</b>	Blue

## Infection Control / Hypochlorite Solution Compatible

Cushion Cover / Power Unit to be wiped down with hypochlorite solution and warm water appropriately diluted.

Use a hypochlorite solution 1,000 parts per million available chlorine. For heavy contamination use a hypochlorite solution 10,000 parts per million available chlorine. Please ensure thorough rinsing after cleaning.

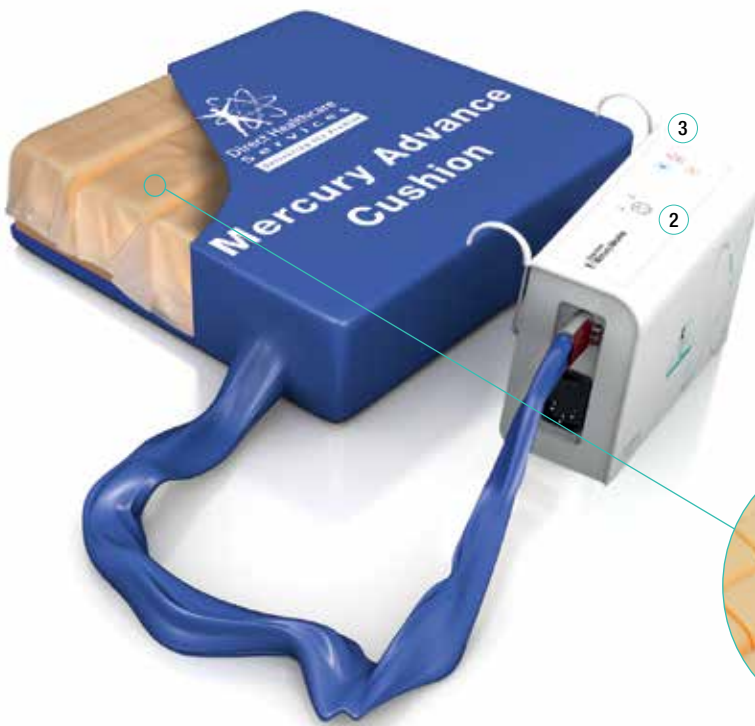

Clinical Application / PU Category



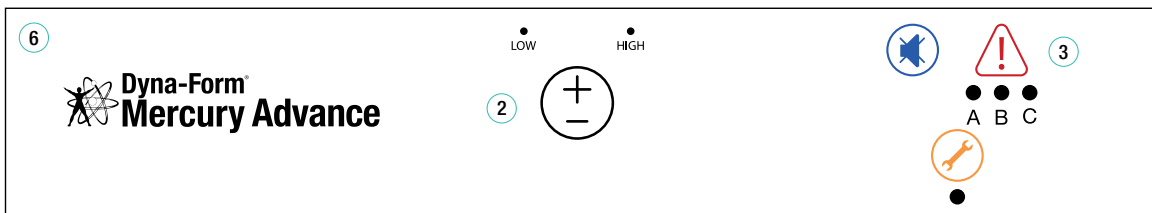
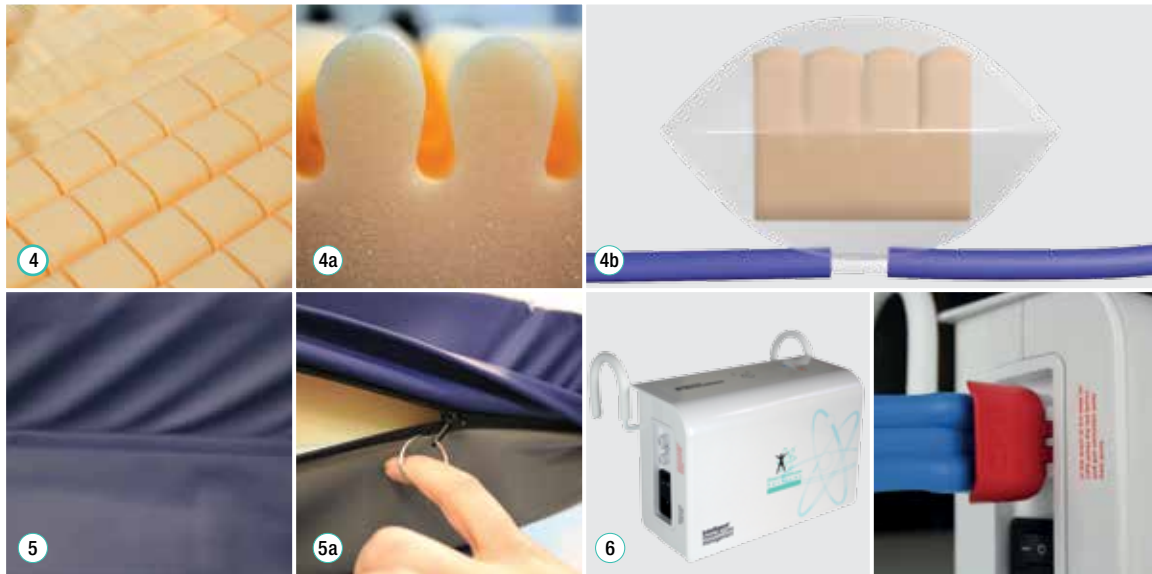

## Features

## Benefits

- |  |  |
|--|--|
| ① Combined foam and dynamic cushion technology   | Provides the ability to upgrade/downgrade to that of patient clinical requirements |
| ② Pressure selection mode  | Providing ultimate patient comfort, without affecting care procedures              |
| Professor led documentation available  | Clinically proven foam cushion   |
| ③ LED alert  | Flashing indicators alert carers of low cell pressures/failure                     |
| ④ Foam cell technology within a cycle of operation<br><b>4a:</b> Close up shot of CME foam castellations within the cell<br><b>4b:</b> Ability to change every individual cell, providing excellent cost management opportunities                        |  |
| ⑤ Minimal weld design with protective zip flap cover, thus preventing ingress or harbouring of skin flora and other bacteria<br><b>5a:</b> "Ring Pull" zip design to aid arthritic hands or other disabilities   |  |
| ⑥ Modern design power unit comes complete with a multitude of functions including: Automatic pressure setting / comfort selection mode, CPR / Static mode functions, Low / High pressure LED and audible warning functions, Illuminating On / Off switch |  |